

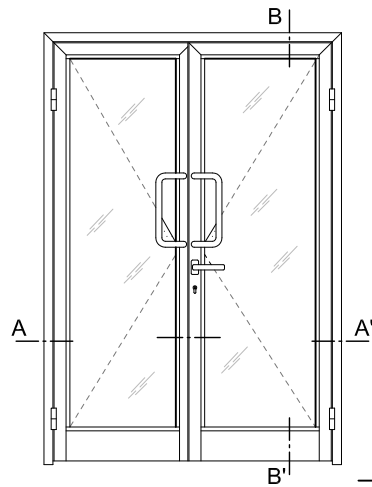

Serie Stilo Puerta

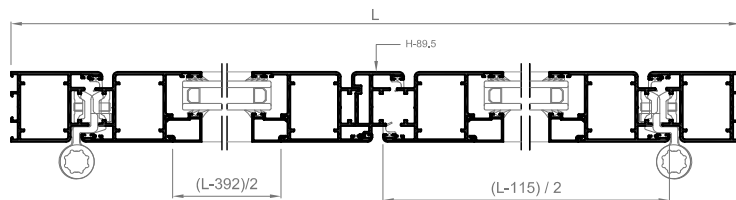

PUERTA 2 HOJAS APERTURA INTERNA



SECCIÓN A-A'

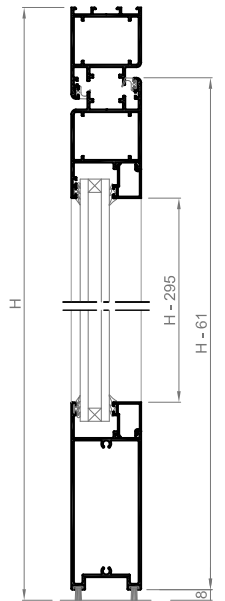

SECCIÓN B-B'

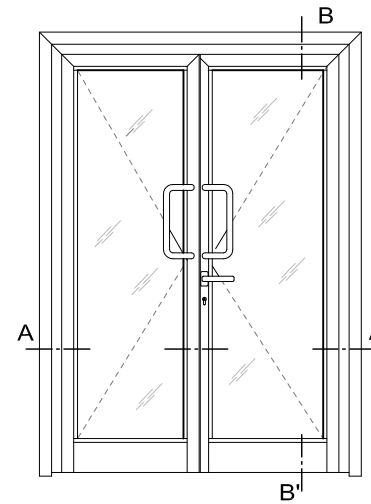

PUERTA 2 HOJAS APERTURA EXTERNA

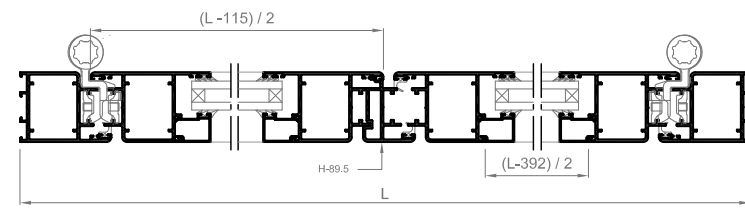

SECCIÓN A-A'

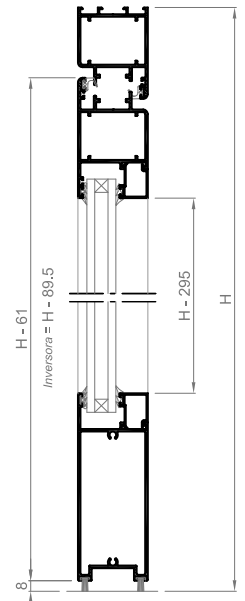

SECCIÓN B-B'

Especificaciones Técnicas

Carpintería practicable lisa al interior y exterior

Cámara Especial

Junta abierta con Doble junta

Sección de Marco 53 mm.

Sección de Hoja 53 mm.

Galce de vidrio de 4 a 38 mm.

Junquillos de altura 22 mm. (Tabla de Acristalamiento 2)

Peso Máximo por Hoja : 180 Kg.

Clasificación Obtenida

Resistencia al impacto de cuerpo blando*

CLASE 5

* Puerta de 2 hojas de 1600 x 2200 mm.

Posibilidades de Apertura

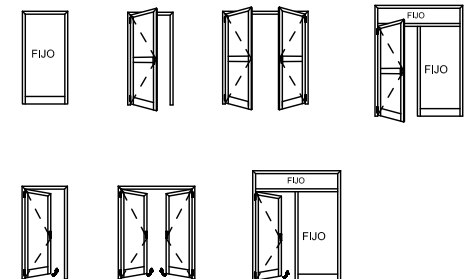

Los ensayos de las ventanas realizados por el grupo Alugom, que son cedidos para la obtención del marcado CE por parte del cliente, se han realizado con los perfiles y accesorios específicos y concretos propuestos por el grupo Alugom, que figuran en los manuales de fabricación de cada serie. Para más información consultar con la sección técnico-comercial del grupo Alugom.

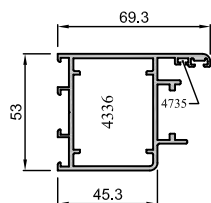

8170

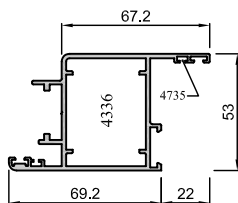

8171

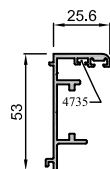

8174

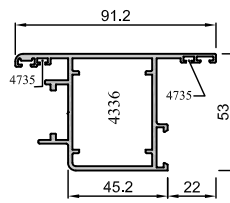

8172

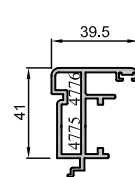

8173

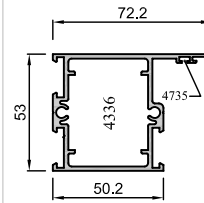

8179

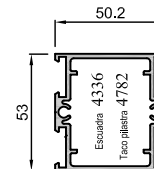

8176

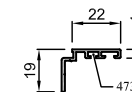

8175

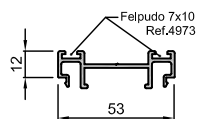

8178

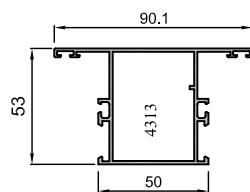

8473

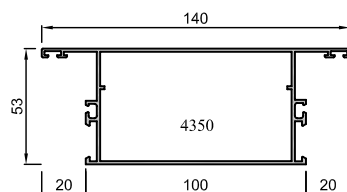

8499

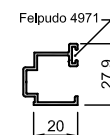

8891

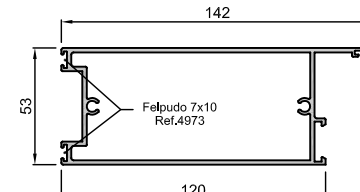

8177

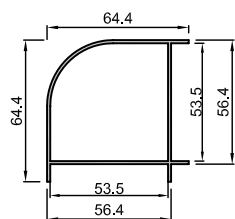

8457

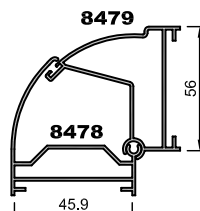

8478

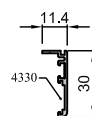

281
1140

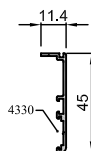

8629

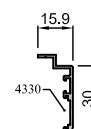

8832

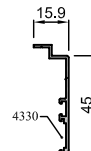

8630

Accesorios

Stilo Puerta

Manillas

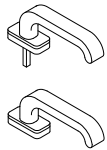

4031

Juego Manilla master
(Colores)

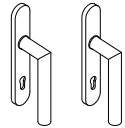

4872

Manilla Puerta
Premium Inox

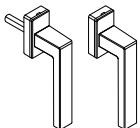

5190

Manilla Kora
c/cuadr. 8 mm

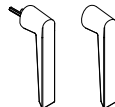

5424

Manilla NP Ultra
c/cuadr. 8mm.

Bisagras

Peso máximo por hoja= 120Kg
(2 Unidades)

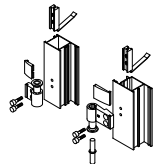

4026

Bisagra puerta Apertura Interna
(Hasta 140 Kg. con 3 Bisagras)

Peso máximo por hoja= 120Kg
(2 Unidades)

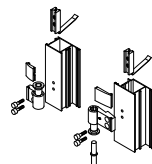

4027

Bisagra puerta Apertura Externa
(Hasta 140 Kg. con 3 Bisagras)

Peso máximo por hoja= 140Kg
(2 Unidades)

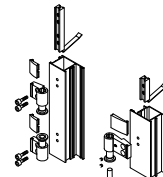

4028

Bisagra 3 alas puerta Apertura Interna
(Hasta 180 Kg. con 3 Bisagras)

Peso máximo por hoja= 140Kg
(2 Unidades)

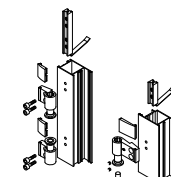

4029

Bisagra 3 alas puerta Apertura Externa
(Hasta 180 Kg. con 3 Bisagras)

Peso máximo por hoja= 100Kg
(2 Unidades)



4770

Bisagra Flash SLR
2 alas

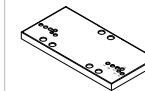

4308

Plantilla Bisagra
61 mm.

Escuadras

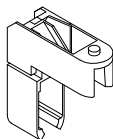

4336

Escuadra Cerco y
Hoja



4735

Escuadra alineamien.
2 mm.

Tacos

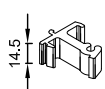

4730

Taco St Pilastras
ancha

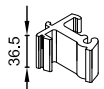

4313

Taco St Pilastras
medianas

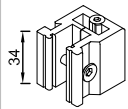

4782

Taco travesaño
simétrico

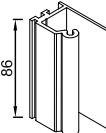

4350

Taco Stilo
manguetón

Elementos de Cierre



4778

Pasadores Hoja
Pasiva ST-PUERTA



5425
Escuadra
junquillos curvos



4078
Pieza sujeción
junquillo curvo



4779
Dedal de suelo
empotrado



4780
Cerradero pasador

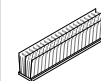

4180
Cepillo Tri-Fin
7x10+2 mm.

Tapas

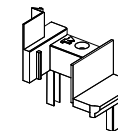

4775

Taco Inversora
Decha. ST-PUERTA

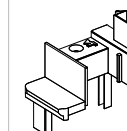

4776

Taco Inversora Izda.
ST-PUERTA



4337
Emb. sal. agua
c/ membrana



4035
Emb. sal.
agua

Juntas



4089

Goma interior acrist.
de 2 a 4 mm.



4090

Goma interior acrist.
de 4 a 6 mm.



4091

Goma interior
acrist. de 6 a 8 mm.



5261

Goma interior
acrist. de 8 a 10 mm.



4057

Goma exterior
acristamiento



4850

Goma exterior
acrist. con alas



4777

Junta perimetral hoja

Detalle Lateral

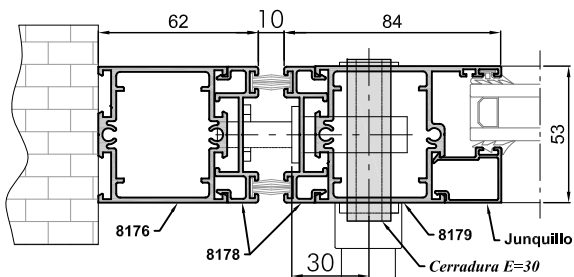

PUERTA VAIVEN

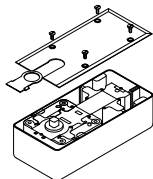

4361

Cierre suelo Vaiven
empotrado c/ cobertura
Límite de apertura = 130°

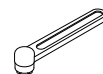

4364

Brazo inferior Vaiven

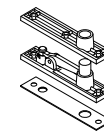

4363

Bisagra superior Vaiven

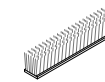

4973

Felpudo Fean Seal
de 7x10 +2 mm.

Utillaje

4781 Juego de Fresas Cerco/ Hoja 53

4841 Útil Múltiple Practicables

4851 Útil Escuadras ST-Puerta

Ver ampliado en *pág. s/Índice:*
- Cerraduras

